

S140

Lift and Slide Door



Modern, versatile and customisable, the S140 Lift and Slide Door combines high performance with contemporary design to provide a reliable aluminium door system for almost any project. Manufactured to the highest UK standards, this multi-configuration system can achieve Thermal U-Values of 0.8W/m²K (Triple glazed) and 1.2W/m²K (Double glazed).

In addition to double and triple track options, a comprehensive range of colours and anodised finishes are available for the system.



DESIGN FEATURES

- › Doc L compliant U-values for refurbishment and new build properties
- › Slimline outer frame with flush frame-sash sight line
- › 2-part triple track profile for ease of fabrication and installation
- › Accepts 24mm - 48mm glazing
- › Max 420kg panel weight

OPTIONS

- › Multiple sliding configurations
- › Double and Triple Track options
- › Available in single, dual colour and anodised finishes
- › Range of hardware and security features
- › Quik Clip
- › Dedicated Cill

SPECIFICATIONS

Performance* and accreditations	S140
U-Value Double Track 2500x2725mm (Double Glazing) 1.0 Ug	1.3 W/m ² K
U-Value Double Track 2500x2725mm (Triple Glazing) 0.5 Ug	0.9 W/m ² K
U-Value Double Track 4982x3100mm (Double Glazing) 1.0 Ug	1.2 W/m ² K
U-Value Double Track 4982x3100mm (Triple Glazing) 0.5 Ug	0.8 W/m ² K
Doorset Energy Ratings (DSER) – Double Glazing	C
Doorset Energy Ratings (DSER) – Triple Glazing	A+
Air Permeability (Pa)	Class 4 (600 Pa)
Watertightness (Pa)	Class 8A (450 Pa)
Wind Resistance (Pa)	Class 4C (1600 Pa)

System

Depth	140 - 217.5mm
-------	---------------

Configurations

Double Track	✓
Triple Track	✓

Size and weight limits

Max Outer Frame W x H: Double Track	4982mm x 3100mm*
Max Outer Frame W x H: Triple Track	6600mm x 3100mm*
Max Vent W x H: Double Track	2500mm x 3029mm*
Max Vent W x H: Triple Track	2257mm x 3029mm*
Max Vent Weight	420kg

Glazing

Glazing Options	Internal
Glazing Thickness	24 - 48mm

Options

Quik Clip	✓
Dedicated Cill	✓

System Features

Single Colour	✓
Dual Colour	✓
Textured Finish	✓
Anodised Finish	✓
Multi-Point Locking	✓
Sightline (interlock)	89mm
Sightline (Cill)	117.6mm
Sightline (Head)	117.6mm
Sightline (Jamb)	117.6mm
Slim Interlock	44mm

*Note: All maximum sizes should be checked against wind load and glass weights. Please contact AluK's technical department for further assistance on sizes and limitations.

CONFIGURATIONS

DOUBLE TRACK



TRIPLE TRACK



KEY



* Performance data based on extended CEN size for Building Regulations. For full test performance details please contact Technical Services. AluK recommends checking all system performance for any scheme prior to use. The maximum height of 3136mm, DOES NOT consider wind loading or glass weights which would need to be checked on each door setup of this size. i.e., if the glass weight is greater than 420 Kg's or the wind load above the interlock inertia values required, the height of the door would need to be reduced to accommodate these limits.

CROSS SECTIONS AND THERMAL PROFILE

Additional details are available on request.

➤ S140 HEAD DETAIL

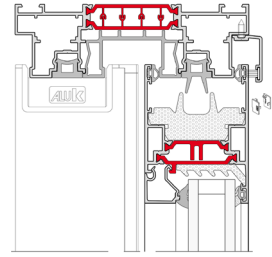

➤ S140 STANDARD THRESHOLD

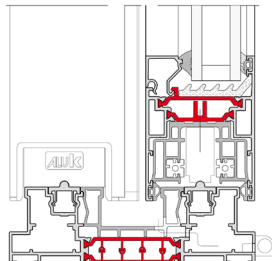

➤ S140 LOCKING JAMB

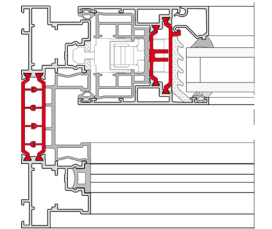

➤ S140 STANDARD INTERLOCK

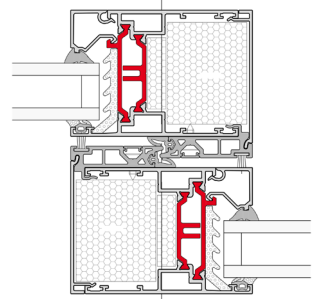

➤ S140 SLIM INTERLOCK

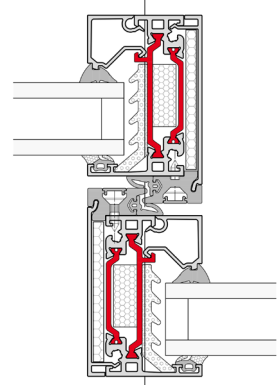

➤ S140 THERMAL PROFILE

